

# Palm grip B20



The palm grip B20 has different equipment options for many requirements. It is compatible with our multi-axis controller or mounted on hydraulic drives. The palm grip has a highly flexible single wire (0,1mm<sup>2</sup>, 450mm long). The mounting piece for the drive rod can be supplied with a tapped hole 12mm.

## Technical data

Operating temperature	-40°C to +60°C
Degree of protection	IP65
Contact complement	1,5A 24V DC13 (*1 0,1A 24V DC13)



	B20L	- 2D	W	K	V21	H13	- X
<b>Basic unit</b>							
B20L	Palm grip left with hand pad						
B20R	Palm grip right with hand pad						
<b>Digital actuating element</b>							
D	Push button KDA21 *1 Colour: red, black, yellow, green, blue, white, orange						
HD	Hall-push button (see page 144)						
W	Rocker switch T-0-T						
W	Rocker switch 0-T						
W	Rocker switch R-0-T						
W	Rocker switch R-0-R						
W	Rocker switch 0-R						
W	Rocker switch R-R						
K	Lever switch						
KT	Cross switch T-0-T/T-0-T						
<b>Analog actuating element</b>							
S12	Hall-Thumb rocker (see page 122) Output 0,5...2,5...4,5V inverse dual						
V21	Hall-minijoystick (see page 61) Output 0,5...2,5...4,5V inverse dual						
P9	Thumbwheel Potentiometer						
H13	Hall-rotary grip Output 0,5...2,5...4,5V inverse dual						
<b>Special model</b>							
X	Special / customer specified						
<b>Attachments</b>							
Z01	Bellow KMD 109				10300009		
Z02	Bellow KMD 190				10300093		
Z03	Rosette KBF 905 with 4 screws M5x15 necessary for bellow KMD 190				5209900404		

Technical details may vary based on configuration or application! Technical data subject to change without notice!

Edition:  
Push button installed  
Cross switch installed

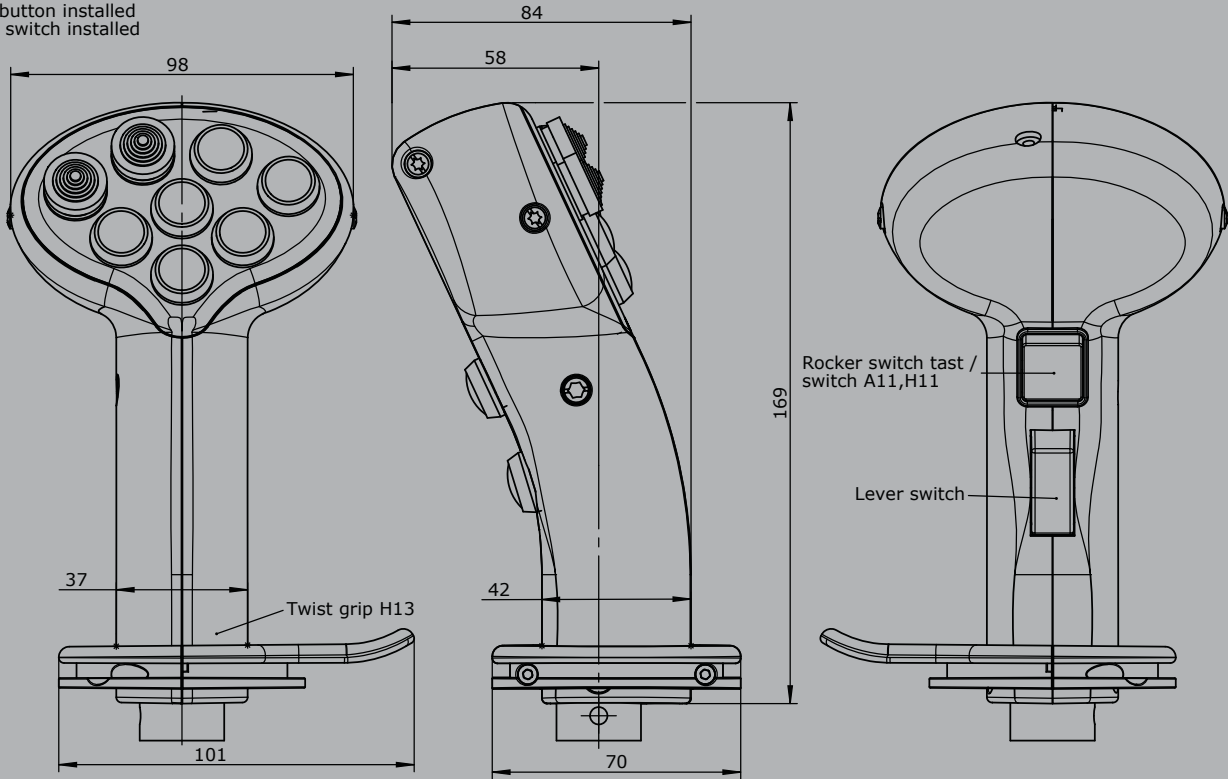

Edition:  
Hall rocker switch  
Push button

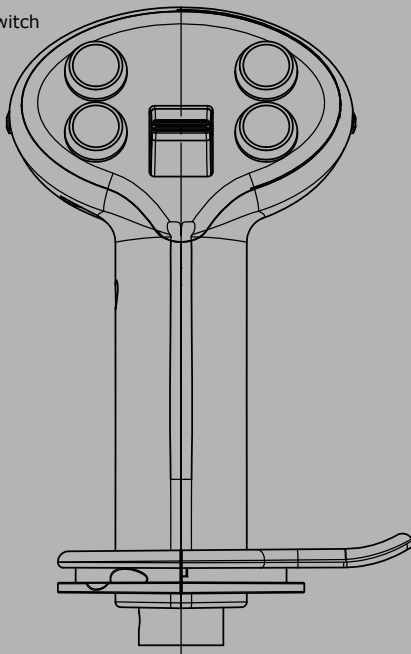

Edition:  
Multi-axis controller V21  
Potentiometer drive PA9  
Push button

